

FIRE PROTECTION: SLIDING DOORS

RATING: -/60/30

SYSTEM: Forster Fuego Light
Insulated Steel Framing System



Incorporating Forster fuego light steel framing system with Pilkington Pyrostop® fire rated glass, these sliding fire doors have been tested and approved to AS1530.4 for fire resistance up to -/60/30 FRL.

Suited for applications that require certified resistance against the spread of fire, whilst retaining the safety and aesthetics of a fully transparent single or double automatic fire rated sliding door. Approved for inclusion within both solid and glazed fire rated walls, with large side and top lites available in a range of FRLs.



FEATURES

- Fire resistance to -/60/30 certified to AS1530.4
- Single and pair configurations
- Assa Abloy SL500 motorised mechanism
- Single leaves to 2760 high x 1150 wide, or 2500 high x 1240 wide
- Overall opening for pairs up to 2760 high x 2312 wide or 2500 high x 2492 wide
- Approved for installation in a variety of wall types, including masonry walls, lightweight plaster walls, and full integration with glazed top and side lites with FRLs of -/60/30, -/60/60, -/90/90, -/120/120 using forster fuego light or forster thermfix vario curtain wall profile systems.
- Class A impact rated 18mm Pilkington Pyrostop® glass
- Suitable for internal or external applications (provided mechanism is protected from weather)
- Powder coated or paint finish to mild steel frame
- System must be activated by FIP or certifier approved system
- Optional vertical and horizontal internal rails
- Upgrade to low iron 23mm (internal) or 27mm Pilkington Pyrostop® Optiwhite
- DWG and DXF drawings, and full architectural support available from TPS



© LOSYS GmbH

DIMENSIONS GRAPH

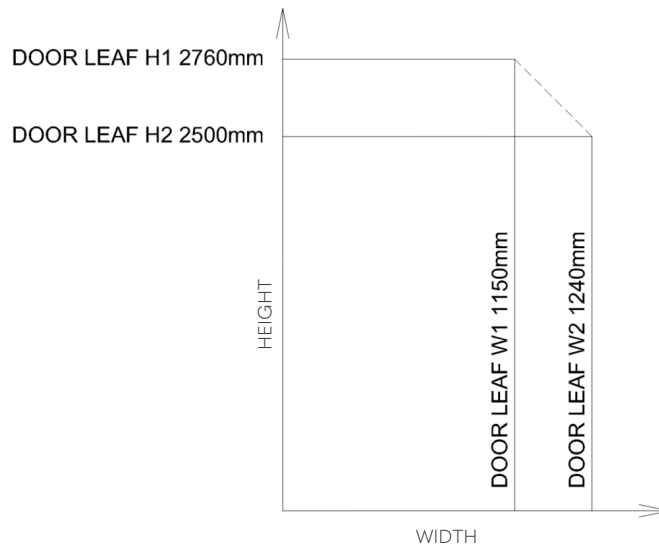

TECHNICAL DATA

	Max leaf height (H)	Max leaf width (W)	Pair configuration max width (PDW)	Max door leaf area (H x W)	Max glass pane height	Max glass pane width	Max glass pane area
Option 1 H1/W1	2760mm	1150mm	2312mm	3.17m ²	2604mm	1014mm	2.64m ²
Option 2 H2/W2	2500mm	1240mm	2492mm	3.10m ²	2344mm	1104mm	2.58m ²

HOW TO SPECIFY

Fire rated sliding door assembly to be tested and certified TPS -/60/30 sliding glazed fire door incorporating insulated forster fuego light steel frame with 18mm Pilkington Pyrostop® fire rated glazing, Assa Abloy SL500 motorised mechanism, fully insulated and controlled by the FIP or alternative to meet the requirements of the relevant certifying authority.

Contact Technical Protection Systems Pty Ltd for further information.

W technicalprotection.com.au P 03 9720 1930 E info@technicalprotection.com.au

TYPICAL ARRANGEMENTS

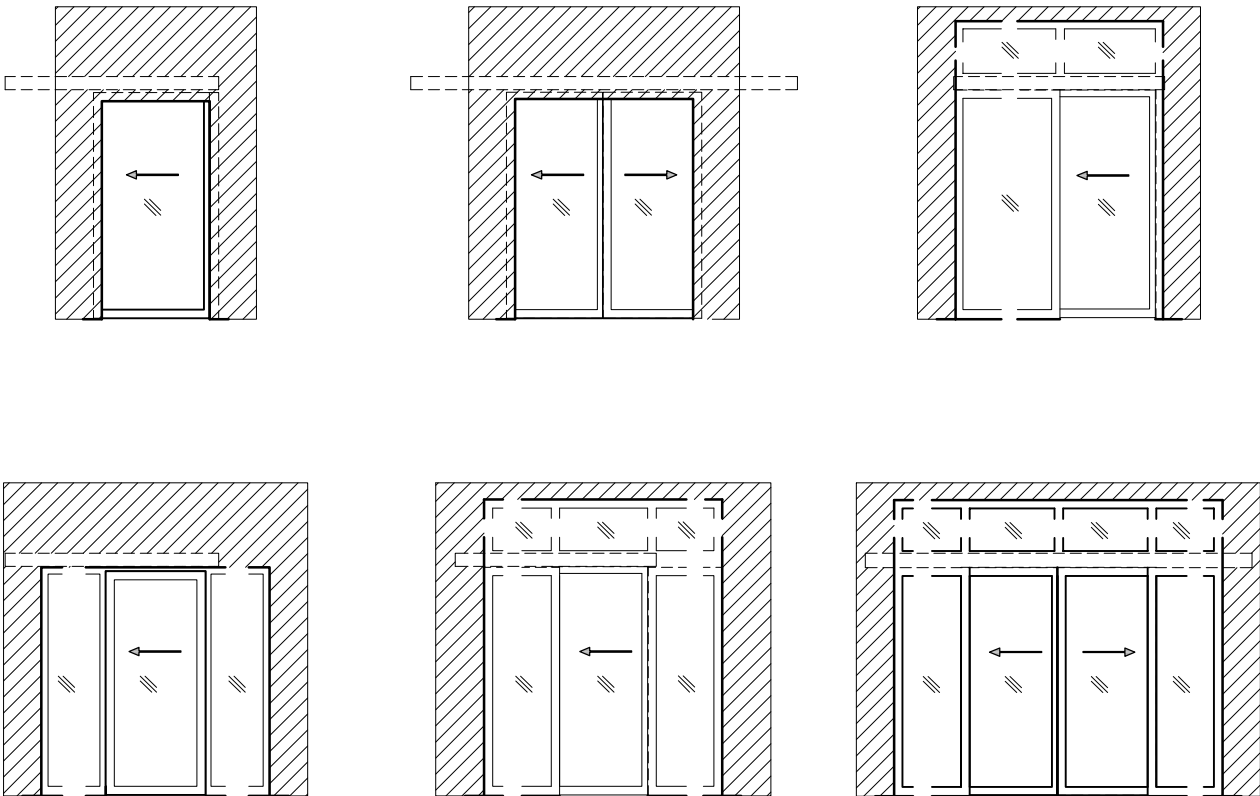

SINGLE AND PAIR DOOR IN SOLID WALL

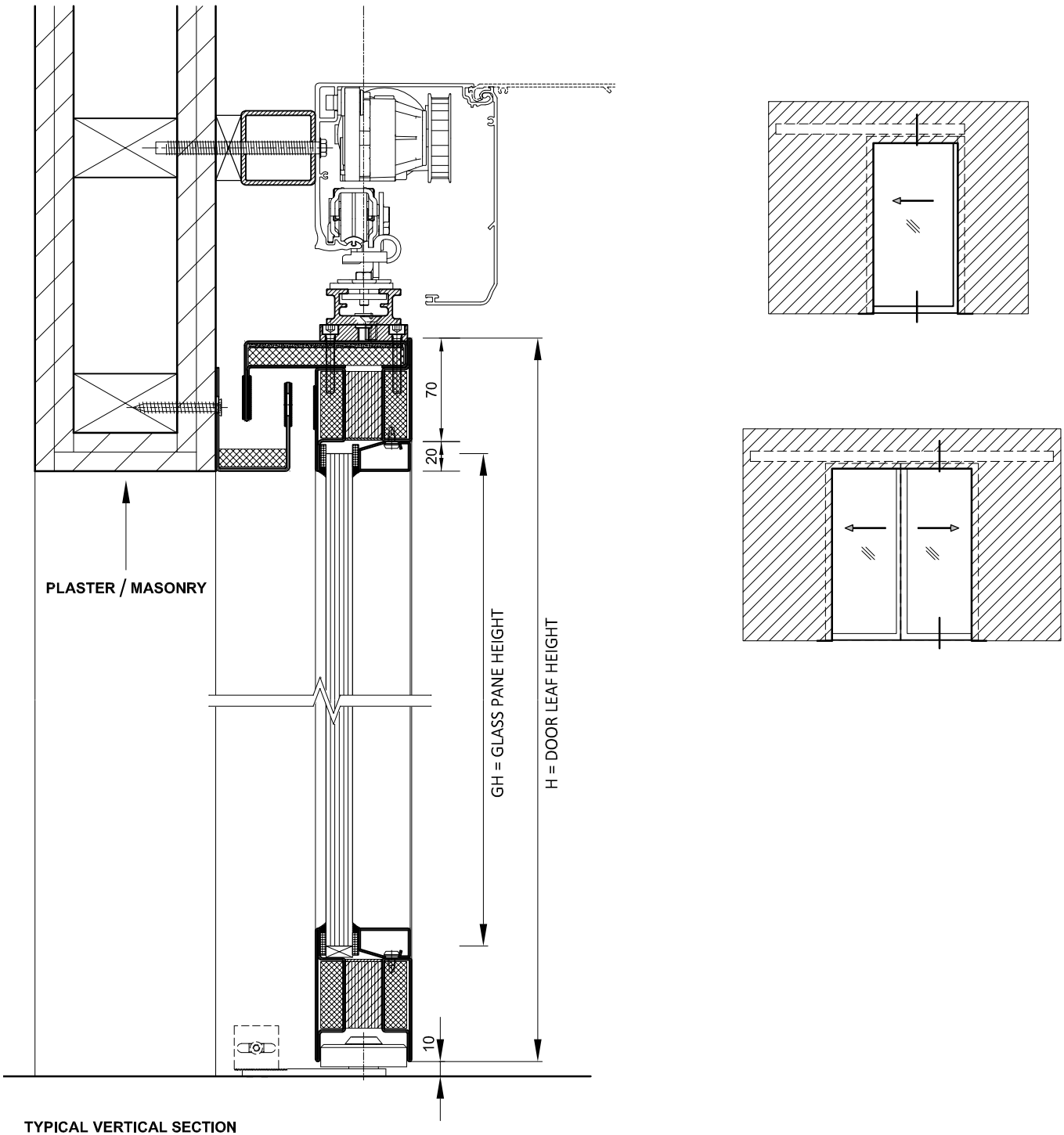

SINGLE DOOR IN SOLID WALL

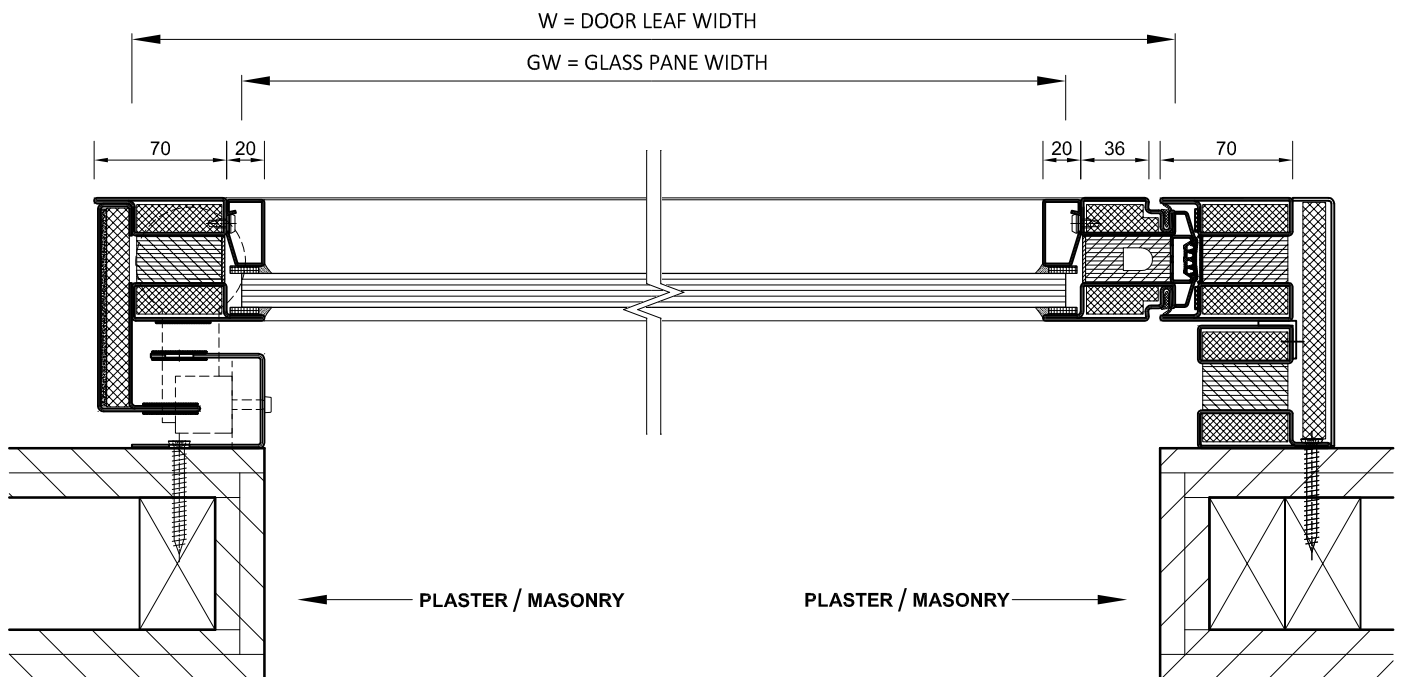
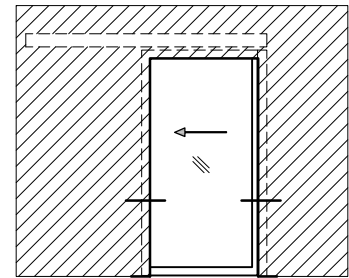

TYPICAL HORIZONTAL SECTION

PAIR DOOR IN SOLID WALL

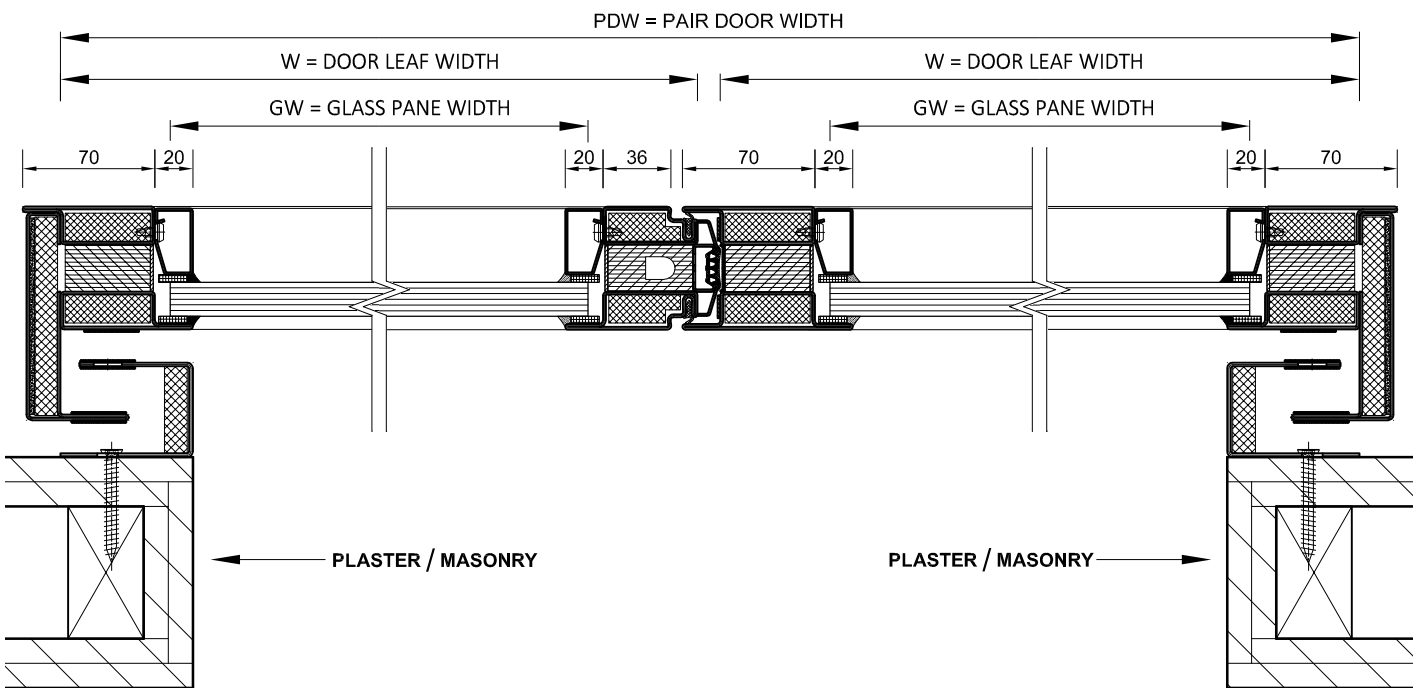
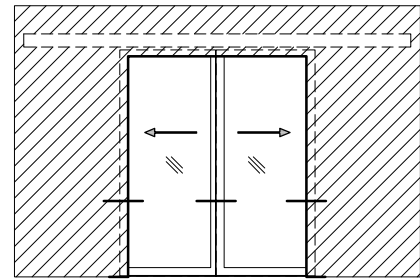

TYPICAL HORIZONTAL SECTION

SINGLE DOOR WITH SIDE LITE

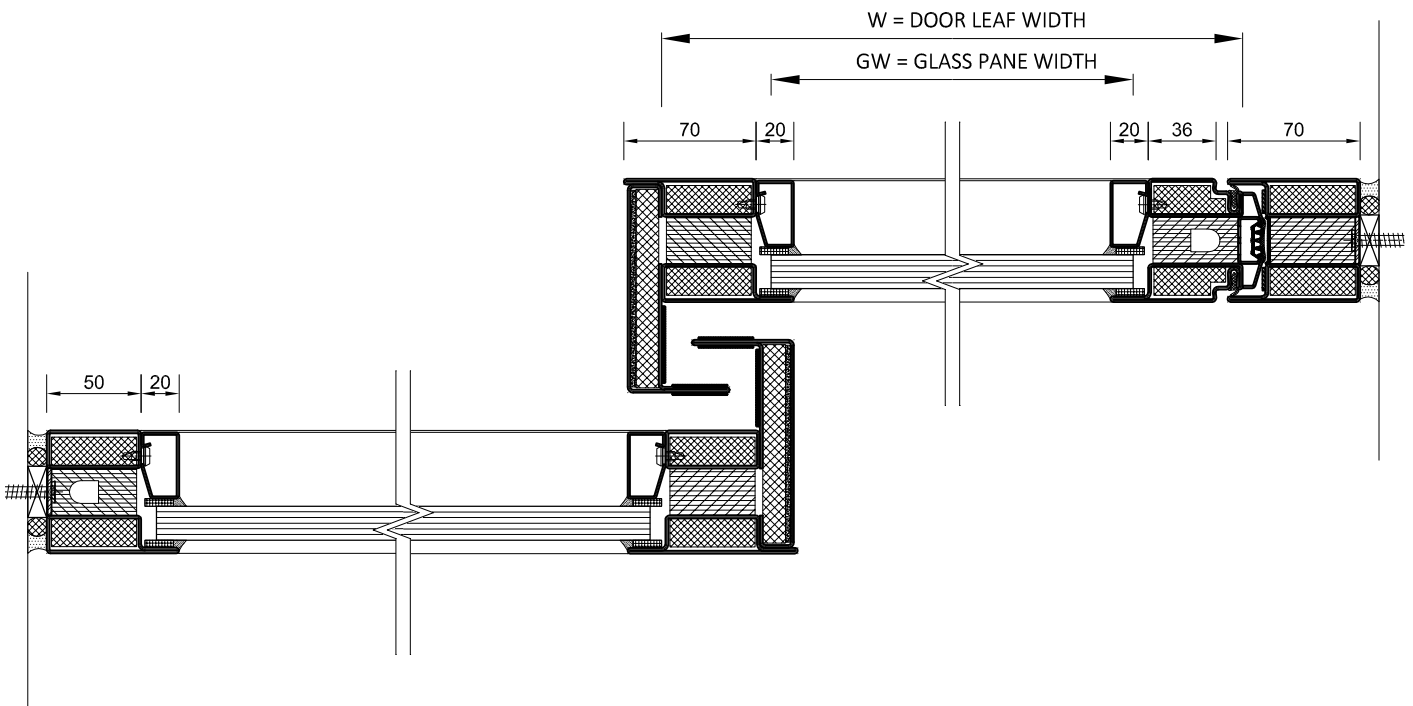
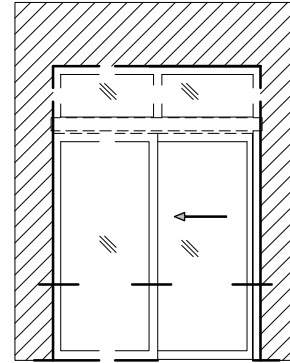

TYPICAL HORIZONTAL SECTION

SINGLE AND PAIR DOOR WITH GLAZED PANEL OVER

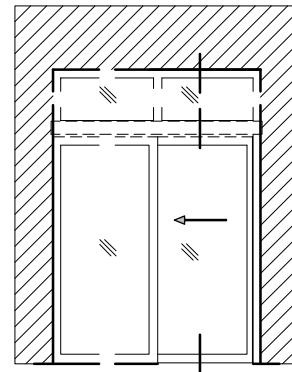
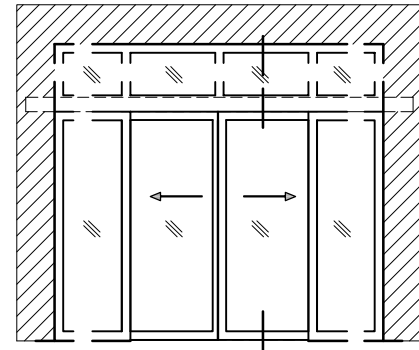
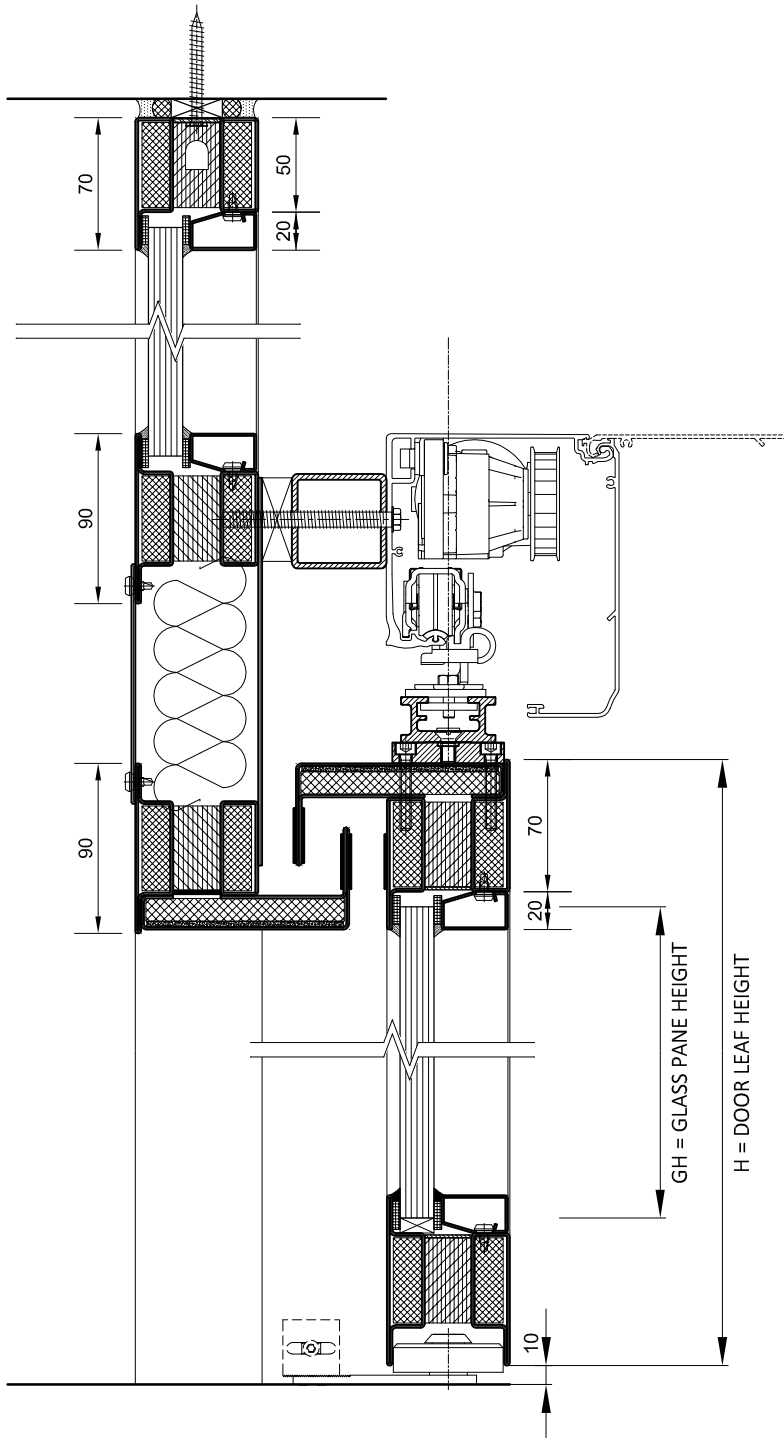

TYPICAL VERTICAL SECTION

SINGLE DOOR WITH SIDE LITES

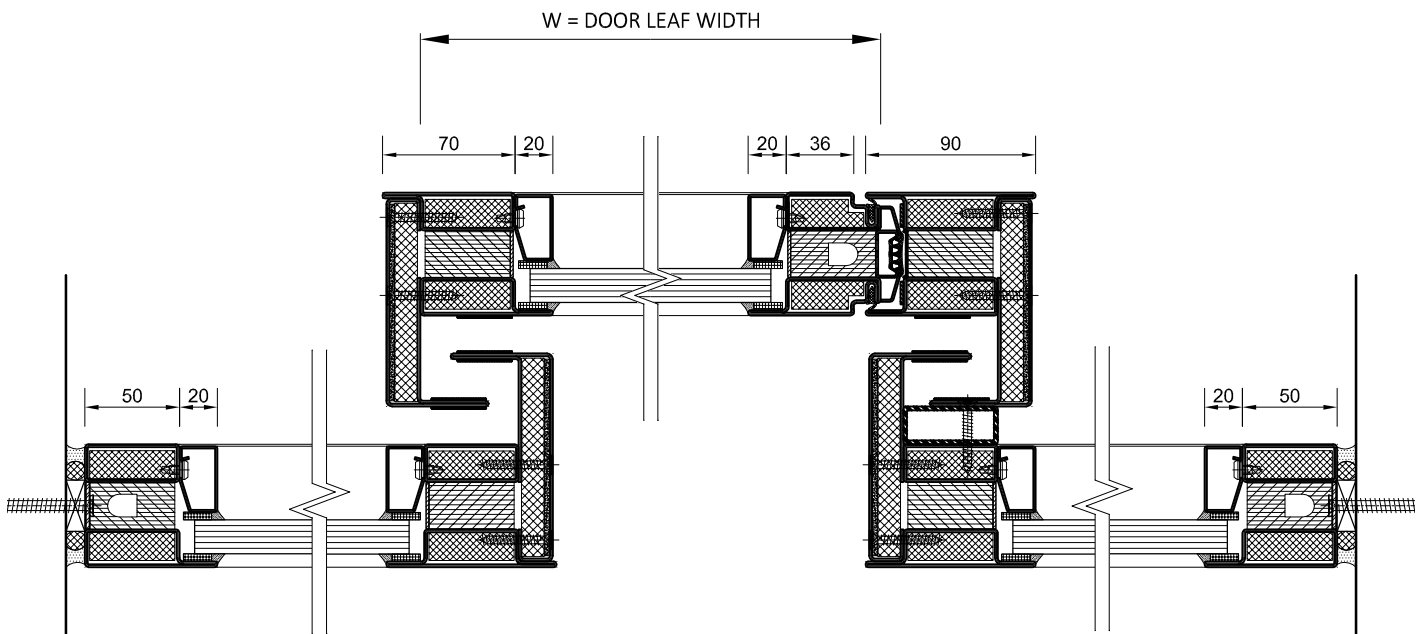
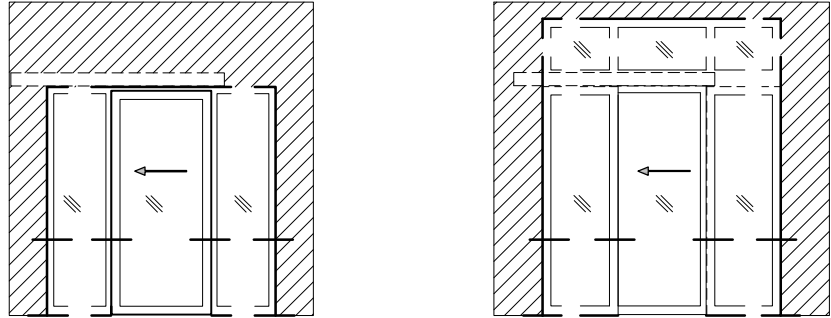

TYPICAL HORIZONTAL SECTION

PAIR DOOR WITH SIDE LITES

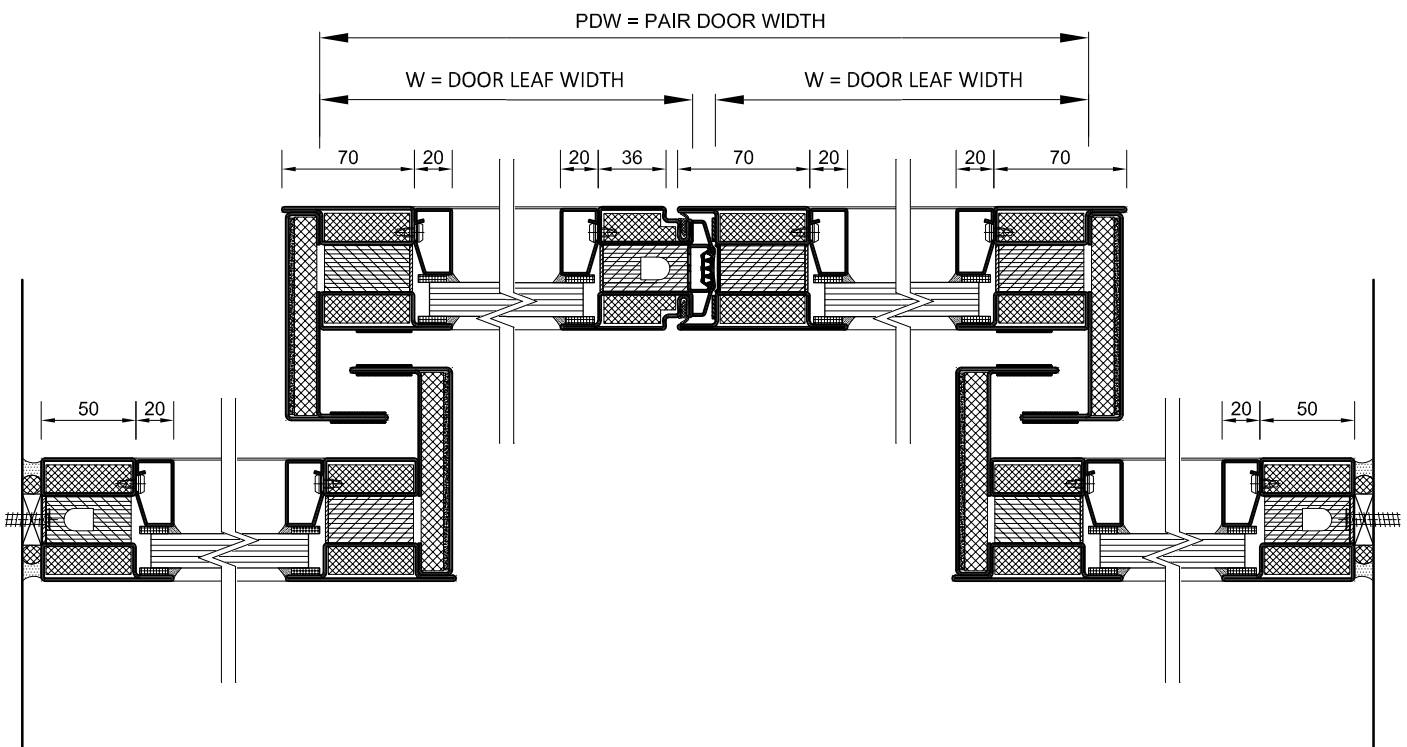
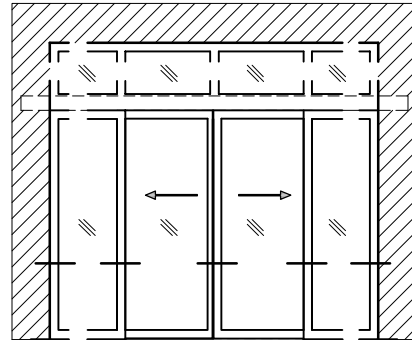

TYPICAL HORIZONTAL SECTION